



DAS Products

DATA SHEET

Low Power Load

LDO-D37-5-xx



- CCI's low power load support 5W across a wideband from DC to 3700 MHz
- Excellent return loss performance
- Available with 7-16 DIN, and 4.3-10 Connectors
- High reliability design
- RoHS compliant

Overview

CCI's low power load covers a broad frequency range from DC to 3700 MHz, while delivering high power performance of up to 5 Watts. This load has excellent return loss performance. The unit is ideal for optimizing RF power distribution, which is often required for distributed antenna systems (DAS).

The extremely wide frequency range allows use with multiband and broadband antennas as well as leaky cable systems. The high power handling makes this load well-suited for use with wireless base stations. The load has been designed and constructed with minimal solder joints which assures the correct dissipative loss and enhances the overall reliability.

The attenuator can be configured with either DIN 7-16 or 4.3-10 connectors.

CCI filter and combiner products are designed and produced to ISO 9001 certification standards for reliability and quality at our state-of-the-art engineering and manufacturing facilities.



DAS Products

SPECIFICATIONS

Low Power Load

LDO-D37-5-xx

Electrical Specification

RF Parameter	
Frequency Range	DC - 3700 MHz
Return Loss	≤ -20.8 dB typ

General Characteristics	
Continuous Average Power	5 W
Impedance	50 ohms

Environmental Specification

Operating Temperature	-35 °C to +65 °C
Ingress Protection	IP20 (Indoor)

Mechanical Specification

Model	LDI-D37-5-Fx
Connectors	7-16 or 4.3-10 Male x 1
Body Dimensions	41 x 20 mm
Dimensions w/Connector	41 mm x M29x1.5
Weight	0.12 kg



SPECIFICATIONS

Low Power Load

LDO-D37-5-xx

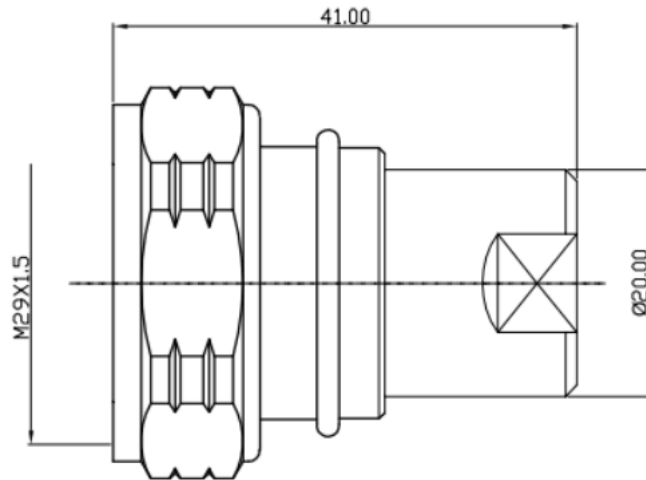

Low Power Load with DIN Male Connector (LDI-D37-5-F1) Outline Drawing

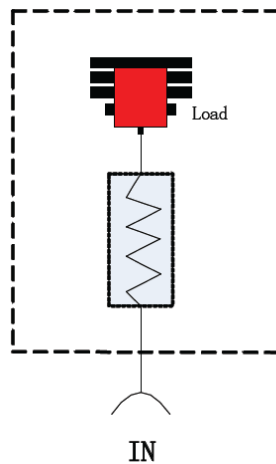

Low Power Load (LDI-D37-5-xx) Block Diagram



DAS Products

STANDARDS & CERTIFICATIONS

Low Power Load

LDO-D37-5-xx

Parts & Accessories

LDI-D37-5-M2	Superseded by LDO-D37-5-M2
LDO-D37-5-M1	Termination load, DC - 3700 MHz, 5W, 7-16 Male Connector
LDO-D37-5-M2	Termination load, DC - 3700 MHz, 5W, 4.3-10 Male Connector
LDO-D37-5-F1	Termination load, DC - 3700 MHz, 5W, 7-16 Female Connector
LDO-D37-5-F2	Termination load, DC - 3700 MHz, 5W, 4.3-10 Female Connector

Standards & Compliance

Safety	EN 60950-1, UL 60950-1
Emission	EN 55022
Immunity	EN 55024
Environmental	IEC 60068-2-1, IEC 60068-2-2, IEC 60068-2-5, IEC 60068-2-6, IEC-60068-2-11, IEC 60068-2-14, IEC 60068-2-18, IEC 60068-2-27, IEC 60068-2-29, IEC 60068-02-30, IEC 60068-2-52, IEC 60068-2-64, GR-63-CORE 4.3.1, EN 60529 IP20

Certifications

Federal Communication Commission (FCC) Part 15 Class B, CE, CSA US, ISO 9001



CCI Communication Components Inc.
EXTENDING WIRELESS PERFORMANCE